

# 88 5528 31

## Colonial Classic Dining Table

### IMPORTANT NOTE

Carefully remove all the parts from the carton and put them individually on a soft cloth to prevent scratches or other damage occuring to the parts.

We have taken great care in the design of this product and request that you carefully and strictly follow our assembly instructions to ensure a completed product as it was designed.

Home  
Styles

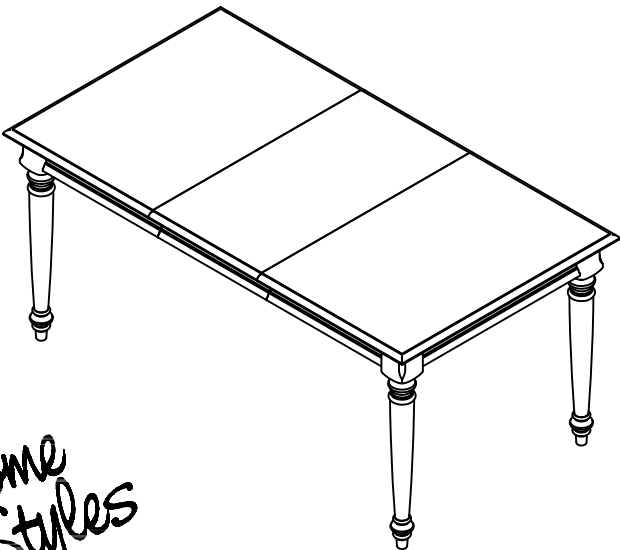

### Part List

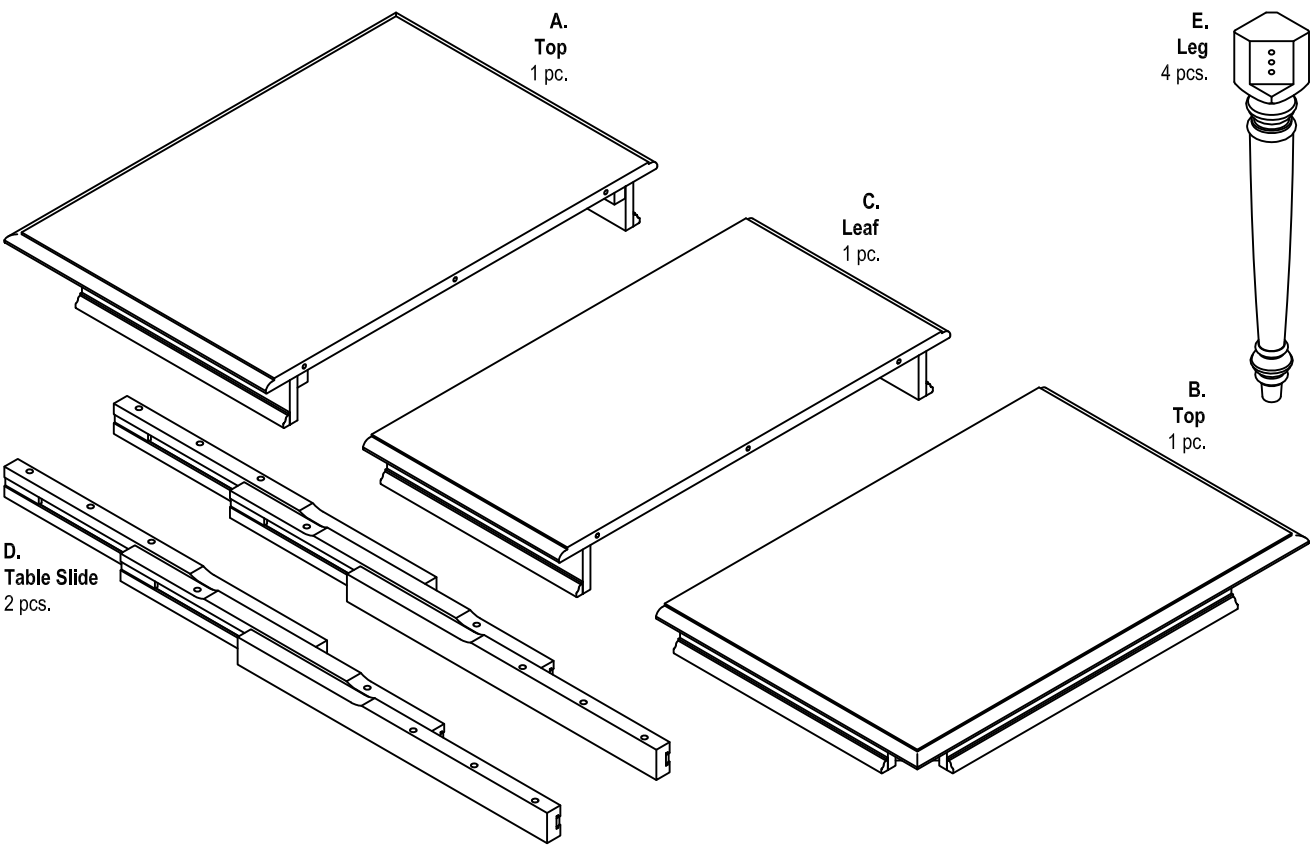

### Hardware List

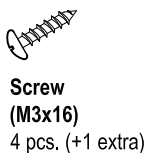
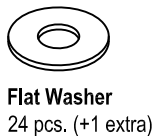

Tools Required For Assembly : Phillips screwdriver

Tools Recommended For Assembly : Level

**Home Styles Consumer Assistance:** [www.homestyles-furniture.com](http://www.homestyles-furniture.com),  
[servicedesk@homestyles-furniture.com](mailto:servicedesk@homestyles-furniture.com), 888-680-7460, 877-831-0319

**IMPORTANT**

- \* Please keep Hex Wrench in a safe place as you may need to tighten up the Head Cap Bolts in the future.
- \* Do not tighten up all the screws until each part is properly assembled.
- \* Use a soft cloth between these parts and the floor.
- \* After assembly, item must be level to work properly.  
Use the included adjustable levellers to level.

**STEP 1**

Place Tops (A) and (B) and Leaf (C) upside down on a soft cloth.

Rotate the Metal Tabs out 90° on Top (B) and Leaf (C) and lock into position using Screws. (see Figure 1)

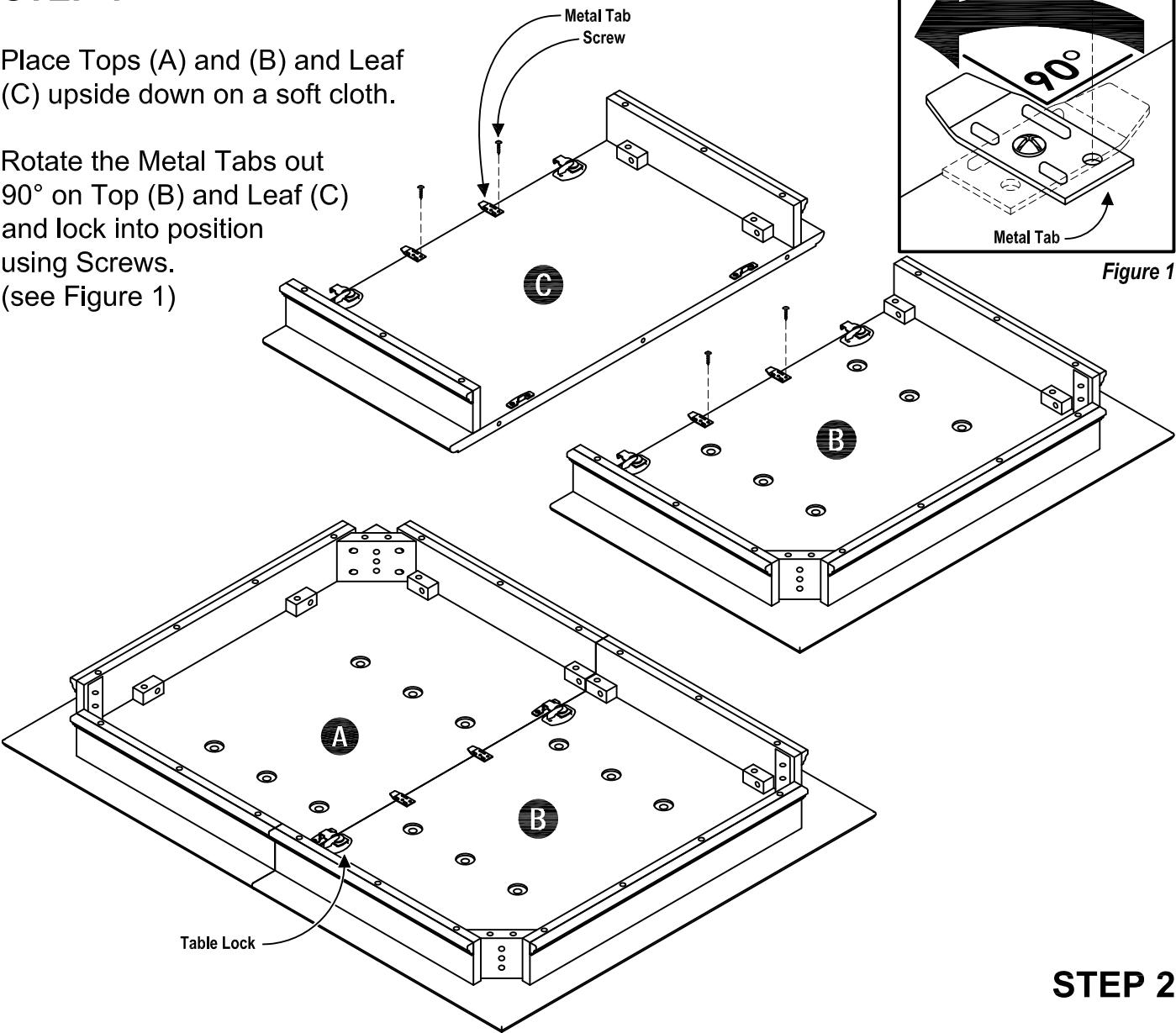

**STEP 2**

Attach Tops (A) and (B) by aligning dowels with the holes and firmly pushing together.

Engage the Table Locks by turning their handles clockwise 1/2 turn. (see Figure 2)

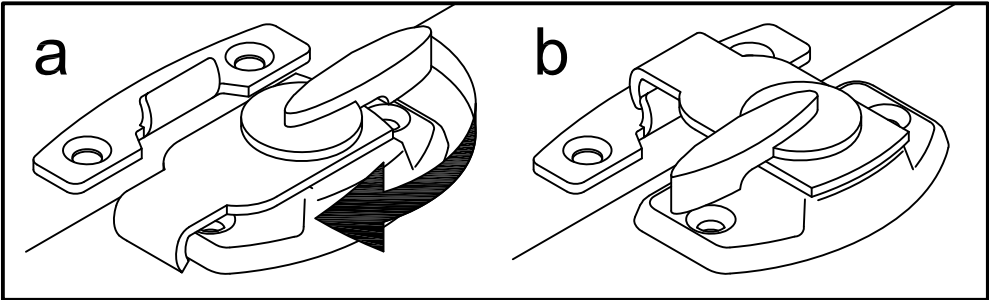
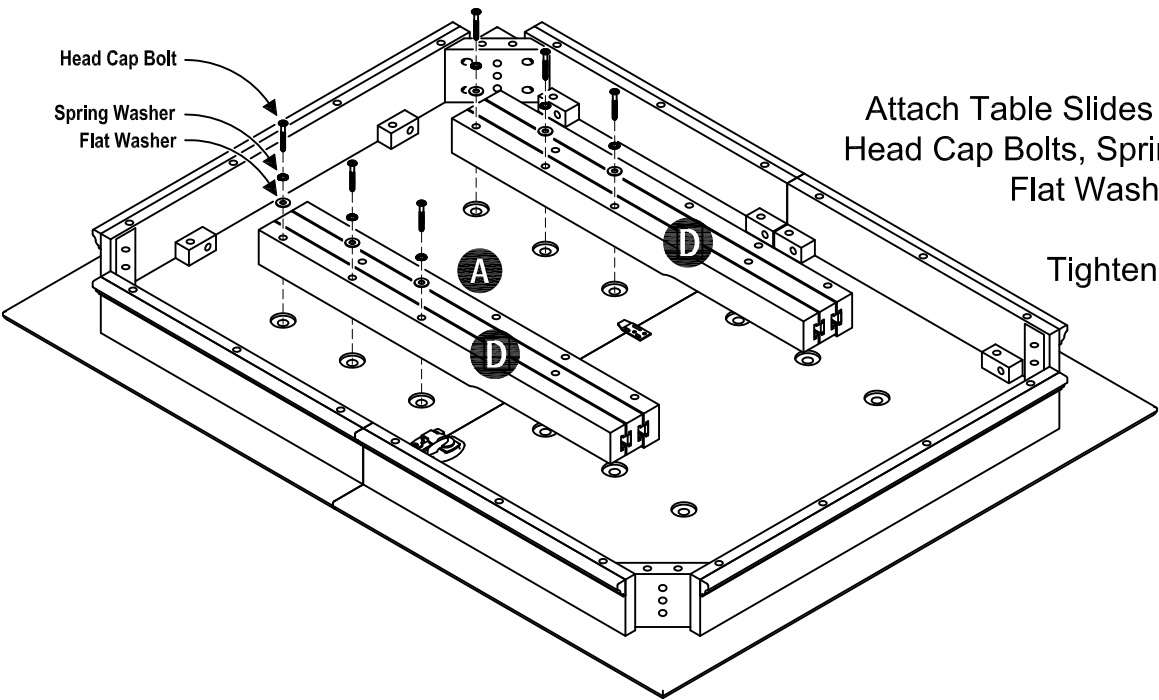

Figure 2

STEP 3



Attach Table Slides (D) to unit using Head Cap Bolts, Spring Washers and Flat Washers into Top (A).

Tighten Head Cap bolts only halfway.

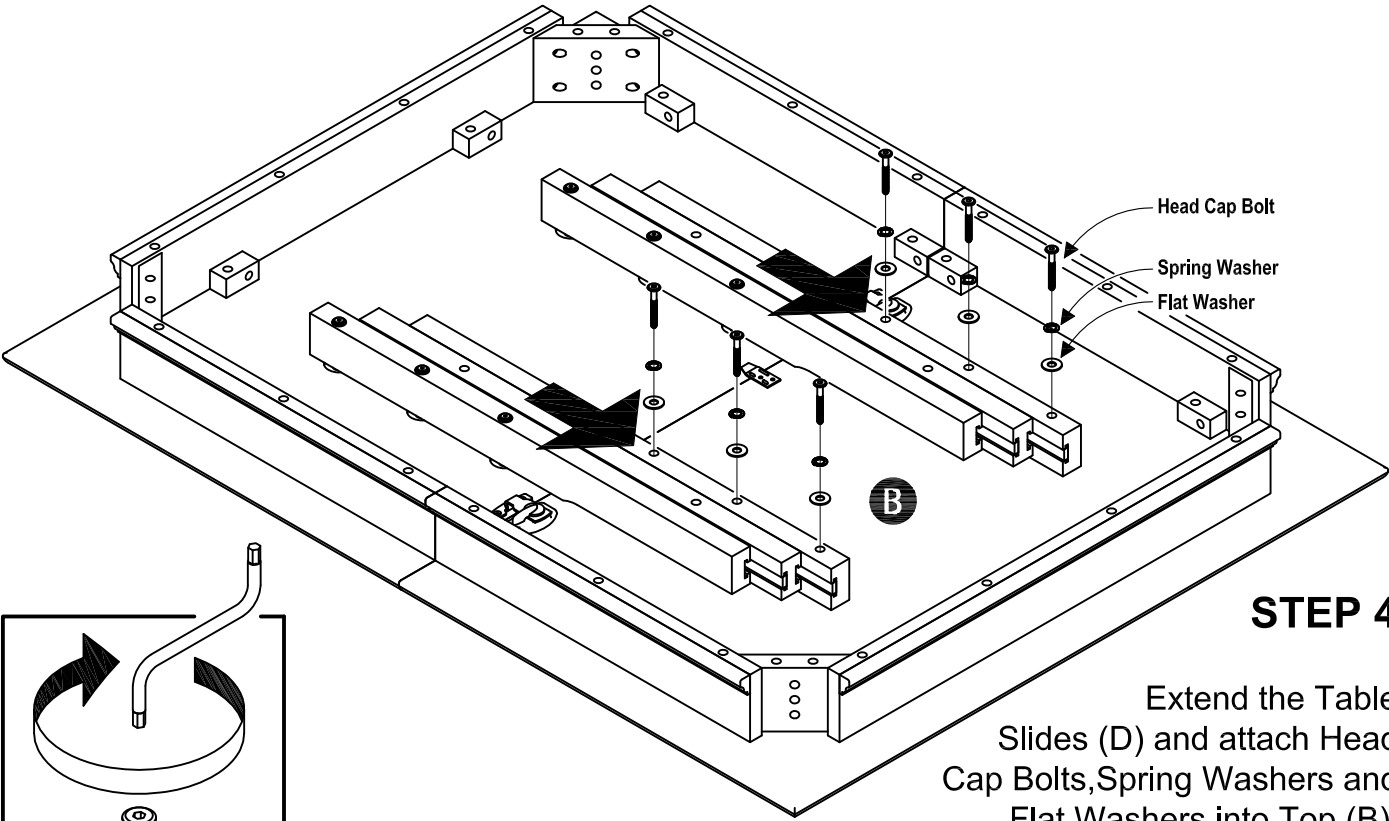

STEP 4

Extend the Table Slides (D) and attach Head Cap Bolts, Spring Washers and Flat Washers into Top (B).

Tighten Head Cap Bolts only halfway.

After Table Slides (D) are attached properly, tighten all bolts completely using Hex Wrench. (see Figure 3)

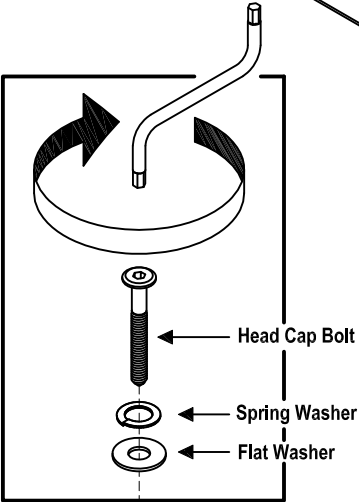

Figure 3

**STEP 5**

Attach Legs (E) to unit using Head Cap Bolts, Spring Washers and Flat Washers.

Tighten Head Cap bolts using Hex Wrench. (see Figure 4)

Turn the table over to its' upright position.

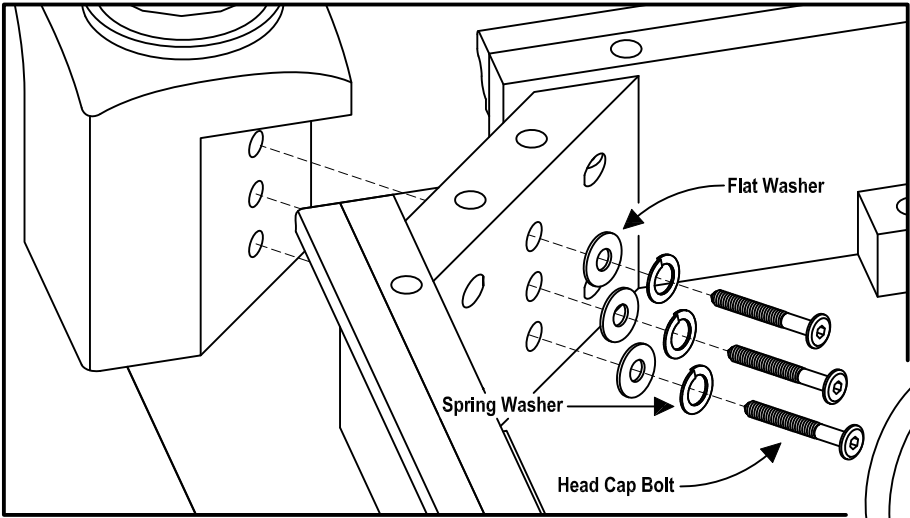
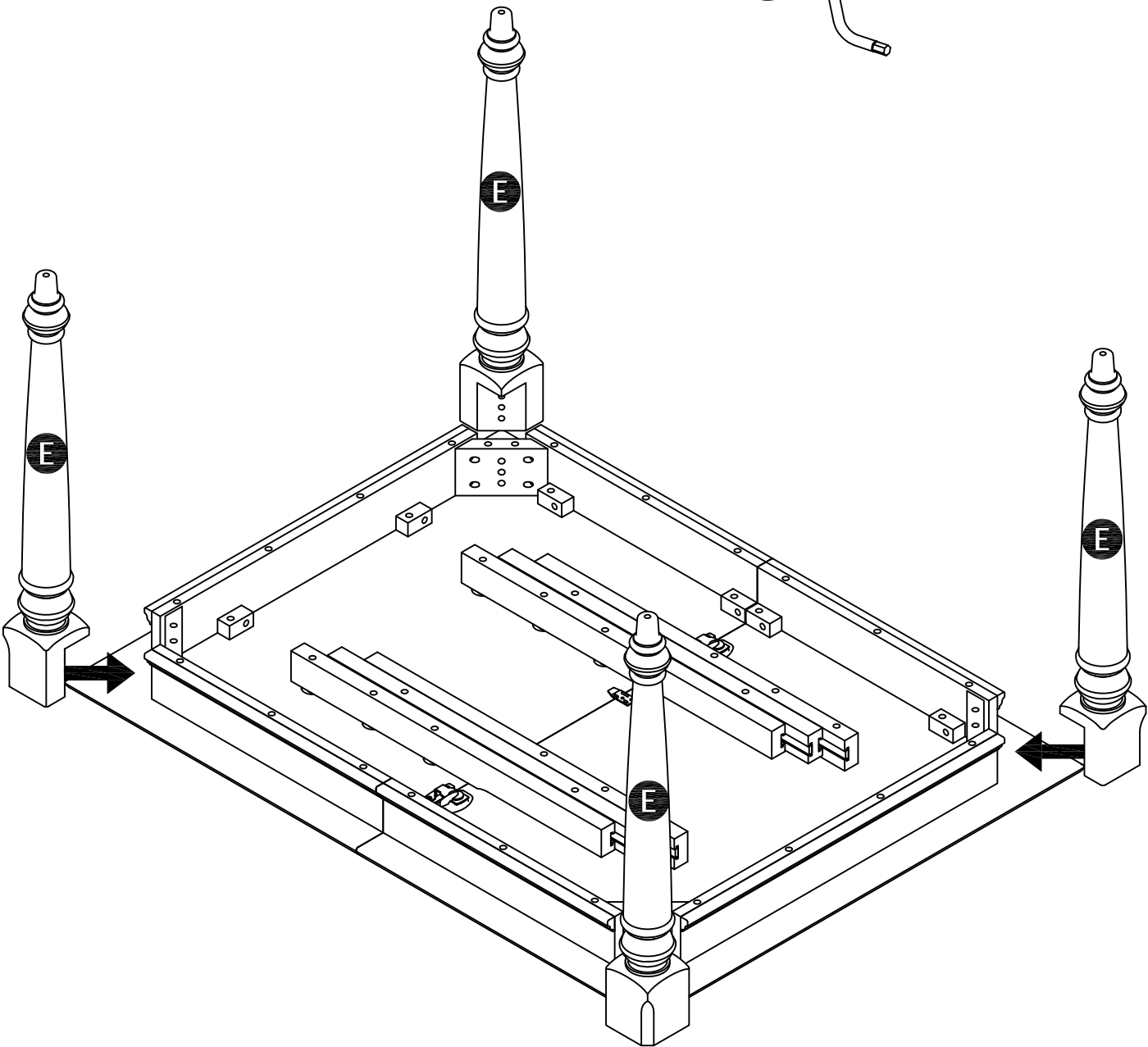
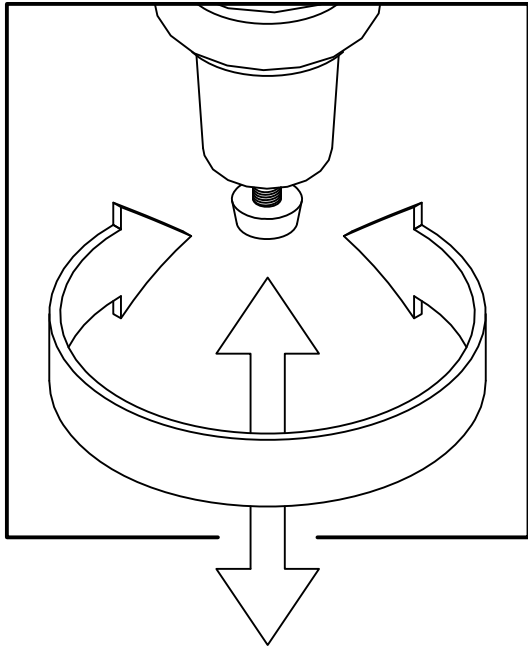

Figure 4



## STEP 6



To level the unit, adjust the adjustable levelers on the bottom of the legs.

**Note: Unit must be level to work properly.**

## ADDING THE LEAF

### STEP 7

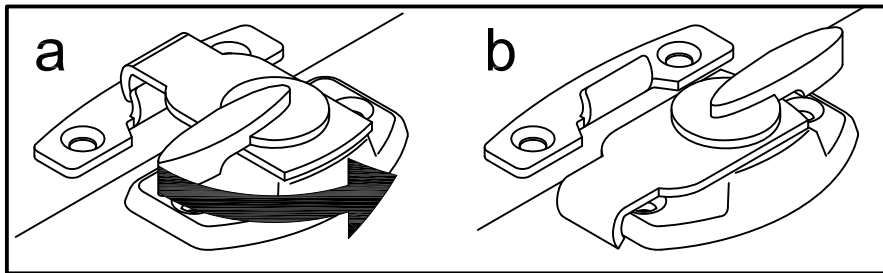

Disengage the Table Locks by turning their handles counter-clockwise 1/2 turn. (see Figure 5)

Figure 5

Pull out both sides of the table, then place Leaf (C) in unit as shown, aligning the dowels with the holes.

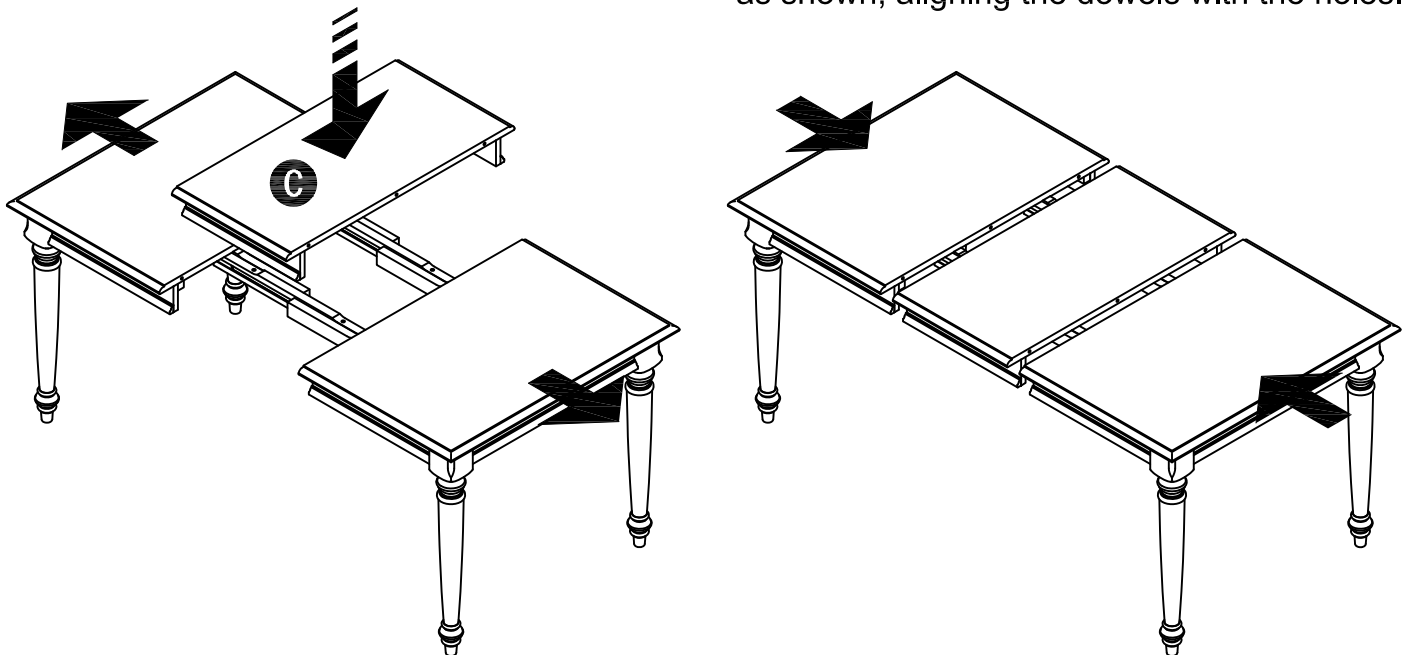

Push the table together firmly then engage the Table Locks by turning their handles clockwise 1/2 turn. (see Figure 2)

# VERY IMPORTANT !!

## CARE INSTRUCTIONS

### NEVER

USE GLASS CLEANERS ON FINISHED FURNITURE. AMMONIA WILL CHEMICALLY ATTACK THE LACQUER.

### NEVER

ALLOW LIQUIDS OF ANY KIND TO REMAIN ON THE FURNITURE. ABSORPTION CAUSES WOOD TO WARP AND SPLIT AND FINISHES TO DELAMINATE.

DO NOT  
WRITE  
DIRECTLY  
ON  
SURFACE.



**PREVENT  
MARKING**

DO NOT  
PLACE IN  
DIRECT  
SUNLIGHT.



**PREVENT  
FADING**

DO NOT USE  
COMMERCIAL  
WAXES AND  
POLISHES.



**PREVENT  
YELLOWING**

DO NOT  
PLACE HOT  
OBJECTS  
ON SURFACE.



**PREVENT  
FINISH DAMAGE**

DO NOT  
USE  
RUBBER  
BASED  
PLACE MATS.



**PREVENT  
DISCOLORING**

## TO CLEAN

USE A SOFT CLOTH MOISTENED IN LEMON OIL POLISH OR LUKEWARM SOAP AND WATER, THEN BUFF WITH A DRY CLEAN CLOTH.



Home Styles will provide replacements free of charge for missing or damaged hardware or parts within 30 days of purchase. Digital images of the defective parts may be required. If this product was not purchased from an authorized retail affiliate, Home Styles is under no obligation to provide replacement parts. Parts are not available for fully assembled items nor are parts available for sale. Replacements for missing or damaged hardware or parts may be requested at:

[www.homestyles-furniture.com/customer\\_service](http://www.homestyles-furniture.com/customer_service)

**Home Styles Consumer Assistance:** [www.homestyles-furniture.com](http://www.homestyles-furniture.com),  
[servicedesk@homestyles-furniture.com](mailto:servicedesk@homestyles-furniture.com), 888-680-7460, 877-831-0319